

PROJECT NAME	
CATALOG NO.	
FIXTURE SCHEDULE	
COMMENTS	

FEATURES

- Leading LED driver design, long lifespan
- Instant Startup, soft light, no glare, no noise, no strobe, effectively alleviates eye fatigue
- Simple and chic and elegant appearance, non discoloring
- Lead-Free and mercury-Free, Saving energy and protecting environment
- 2.4G wireless CCT adjustable & Watt adjustable light, strong penetration, remote control can work up to 30 meters also wall type remote controller up to 20 meters.
- Compatible with 0-10V dimming function – Color & Wattage not adjustable



- Input voltage: AC 100-277V
- PF: >0.9, THD: <15%
- Battery backup optional
- Working Temp: -20~50°C/-4~122°F
- Working Humidity: 23~70%RH
- IP Grade: IP40
- LED TYPE: Epistar SMD 2835
- Shock Grade: Class II
- Lifespan: 50,000 Hours
- 5-Year limited warranty



SPECIFICATIONS

MODEL	SIZE	WATT (W)	LUMEN (LM)	LUMEN (LM/W)	CRI (RA)	PF	VOLTAGE (V)	BEAM ANGLE	CCT ADJUSTABLE RANGE (K)	DIMENSION	WEIGHT	IP	CHANGEABLE WATTAGE
OMJ7-SFP-14-40	1x4FT	40	4200	105	>80	≥0.9	120-277	120°	3000-5000	1213x301x10mm/47.76x11.85x0.39"	3.8kg/8.38lb	40	By remote control
OMJ7-SFP-22-40	2x2FT	40	4200	105	>80	≥0.9	120-277	120°	3000-5000	603x603x10mm/23.73x23.74x0.39"	3.7kg/8.16lb	40	By remote control
OMJ7-SFP-24-60	2x4FT	60	6300	105	>80	≥0.9	120-277	120°	3000-5000	1213x603x10mm/47.76x23.74x0.39"	7.2kg/15.87lb	40	By remote control

SPECIAL ORDER (UPON REQUEST)

MODEL	SIZE	WATT (W)	LUMEN (LM)	LUMEN (LM/W)	CRI (RA)	PF	VOLTAGE (V)	BEAM ANGLE	CCT ADJUSTABLE RANGE (K)	DIMENSION	WEIGHT	IP	CHANGEABLE WATTAGE
OMJ7-SFP-22-36	2x2FT	36	3780	105	>80	≥0.9	120-277	120°	3000-5000	603x603x10mm/23.73x23.74x0.39"	3.7kg/8.16lb	40	By remote control
OMJ7-SFP-22-45	2x2FT	45	4725	105	>80	≥0.9	120-277	120°	3000-5000	603x603x10mm/23.73x23.74x0.39"	3.7kg/8.16lb	40	By remote control
OMJ7-SFP-24-50	2x4FT	50	5250	105	>80	≥0.9	120-277	120°	3000-5000	1213x603x10mm/47.76x23.74x0.39"	7.2kg/15.87lb	40	By remote control
OMJ7-SFP-24-70	2x4FT	70	7350	105	>80	≥0.9	120-277	120°	3000-5000	1213x603x10mm/47.76x23.74x0.39"	7.2kg/15.87lb	40	By remote control

THE HAND-HELD REMOTE CONTROLLER



- The remote controller can control 4 groups of Flat Panels systems, the number of lights of each group is UNLIMITED
- After turning on the Flat Panels, the lights will automatically detect 0-10V dimmer (if present) to set the brightness. If it does not detect a Dimmer Signal it will set itself to 100% brightness

Conflict using 0-10V Dimmer

- If you use 0-10V dimmer to control the lighting and the brightness – it will revert to the Dimmer settings for Dimming and Brightness – **The Remote Control will be ineffective.**
- If you use the Remote Controller (only for OMJ7-SFP systems) to control the lights brightness and color, it **will be effective.**

	ON/OFF		SAVE PROGRAMMING		ID		DELAY		INDICATOR
--	--------	--	------------------	--	----	--	-------	--	-----------

How to connect LED Panels to the remote controller (Matching code for lights)

- Panels AC Power off
- Press and hold the button . The controller RED indicator light on.
- Panel AC Power on. Light will flash twice immediately. Then release the button .

How to disconnect LED Panels from the remote controller

- Panels AC Power off
- Press and hold the button + together. Lights flash – releasing program code.
- Panel AC Power on. The light will flash to finish releasing the code on the lights.

How to make Groups (When press the button , all groups work together)

- Panels AC Power off (These LED panels will be a group)
- Press and hold one of groups for 3sec. (Unlimited number of lights per group.)
- Panels AC Power on to finish grouping. (Operating: Press group button first then press other buttons)

Delay turn-off Press delay button then the light will be turned off the after 10sec.

Save Settings After selecting color temperature , brightness , then press the button for 3sec. (The light will be turn on for the saved setting)

: Increase brightness : Decrease brightness : High color temperature : Low color temperature

THE MATCHING METHOD OF HAND-HELD REMOTE CONTROLLER AND WALL-TYPE REMOTE CONTROLLER.

THE WALL TYPE REMOTE CONTROLLER

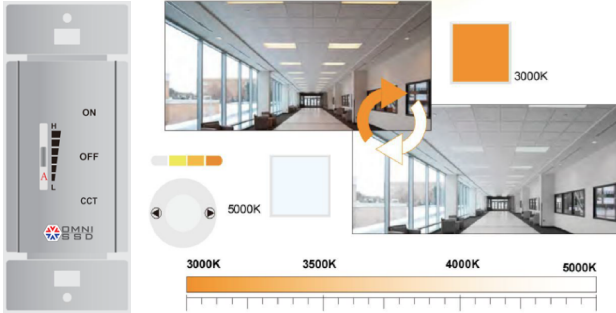

CCT can be adjusted between 3000K-5000K as you wish.

After 10 seconds of each operation, it will enter the standby power saving mode. If you need to adjust again, please press the ON button, it works after the indicator flashes.

* After turning on, the lights will automatically detect the 0-10V dimmer to set brightness, it will go to 100% brightness if no dimming signal is input to the light.

* If using 0-10V dimmer to control the brightness, the dimmer's current setting will adjust brightness.

ON OFF	Turn on Turn off
A	Brightness adjustment
ON + OFF	*Notice: If you need to use both remote controller and wall mount controller for same light, please DO NOT USE this function.* Pressing the buttons "ON"+"OFF" simultaneously to keep remote controller's indicator light always on, turn on the light for 2 seconds then release the combination keys, matching code finished. Matching code with many lights at the same time is available.
CCT	Press the CCT button, color temperature will circularly change among 3000/3500/4000/5000K. After shutting down will save the current color temperature.

Works in conjunction with hand-held remote

NO	GROUPING	HAND-HELD CONTROLLER	WALL-TYPE CONTROLLER
1	1	1 + ID	ON + CCT
2	2	2 + ID	ON + CCT
3	3	3 + ID	ON + CCT
4	4	4 + ID	ON + CCT
5	ALL	ALL + ID	ON + CCT

DIMENSIONAL DRAWING

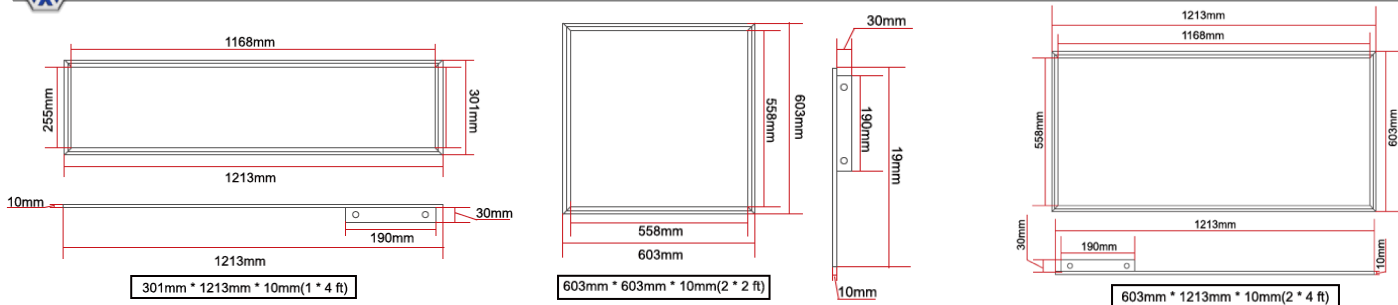

INSTALLATION DIAGRAM

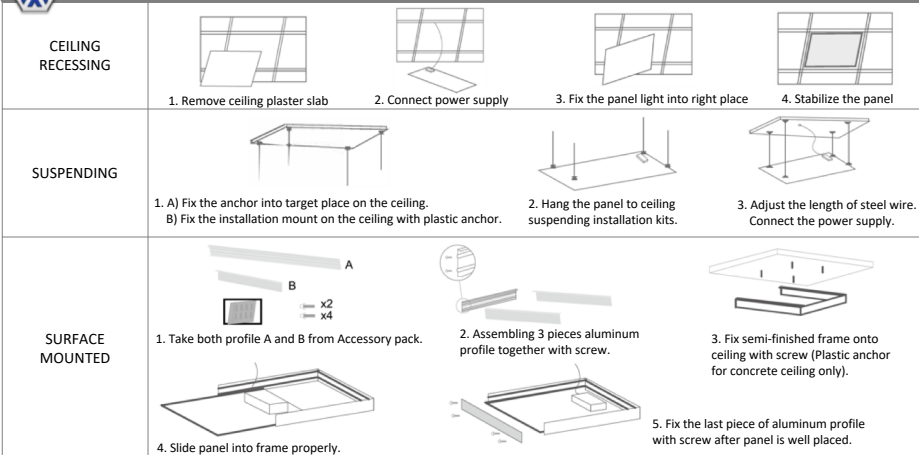

1. With the mounted skeleton of gypsum board size, otherwise it cannot enter or it will easy to fall off.
2. Ensure the skeleton can bear the weight of LED light before installation.
3. Disconnect power switch before installation.
4. Must be insulated when connect wires, to prevent short circuit or electric shock, copper wire cannot be exposed.
5. Place the power supply at a reasonable and safe position for convenient change or maintenance in order to avoid affecting ventilation and radiating and prevent fire, there should not be any items within 50mm around power pack, especially flash point below 80 degree items.
6. This product is for indoor only, no waterproof function. Can't using outdoor or in damp places.
7. **This product has dimming function, can be used with dimmer.**
8. Store products in cool, dry and clean environment if unused for long time.
9. Non-professional person cannot open or to maintain, otherwise, warranty not given.

APPLICATIONS



Mainly suitable for commercial lighting and residential lighting. Widely used in Office building, plants, schools, Supermarkets, hotels, meeting room, exhibition hall, Underground garage and all places need energy saving and high CRI.

PACKAGE

ITEM SIZE	N.W	CARTON SIZE (mm)	QTY	G.W
2x2 FT	3.7kg/pc	650x645x170	4pcs/CTN	16.8kg/CTN
2x4 FT	7.2kg/pc	1255x645x85	2pcs/CTN	16.4kg/CTN
1x4 FT	3.8kg/pc	1250x345x170	2pcs/CTN	17.2kg/CTN